



The Quick Line series was conceived to respond to two main issues raised by the market:

- necessity of compact, easy-fitting conveyors, suitable for different uses and especially where limited space is a crucial element (e.g. under IMM)
- reduction of transport costs, which sometimes can considerably impact on the final price

**THE NEW QUICK LINE SERIES INCLUDES COMPACT CONVEYORS WHICH CAN BE INSTALLED IN LIMITED SPACES, WITH A SPECIAL PACKING SOLUTION TO ALLOW FLEXIBLE USE AND A CONSIDERABLE REDUCTION IN TRANSPORT COST.**



The special removable housings allow to flatten the conveyors with change of direction.



Considerable reduction of volume, leading to significant cuts in packing and transport cost.

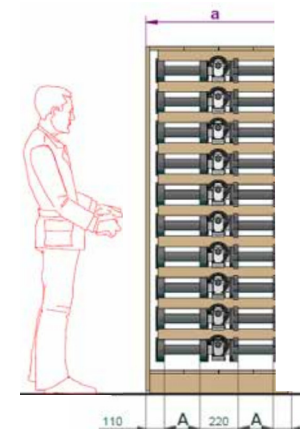

**CONSIDERABLE TRANSPORT COST REDUCTION**

**PACKAGING OPTIONS**

	NUMBER OF CONVEYOR	A	B	H
KNIGHT	up to 7 (single row)	$A + 345$	$C + B + 200$	no. of conveyors (max 7) x 180 + 400
	from 8 to 20 (double row)	$2 \times A + 440$	$C + B + 200$	no. of conveyors (max 10) x 180 + 400
BISHOP	up to 7 (single row)	$A + 345$	$C + B + D + 200$	no. of conveyors (max 7) x 180 + 400
	from 8 to 20 (double row)	$2 \times A + 440$	$C + B + D + 200$	no. of conveyors (max 10) x 180 + 400

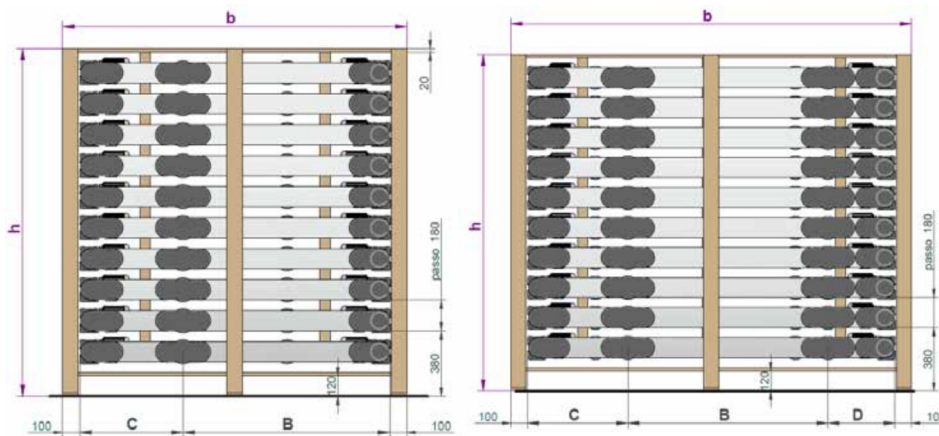

**WE CAN SHIP UP TO  
7 CONVEYORS OVERLAPPED  
ON A SINGLE ROW!**

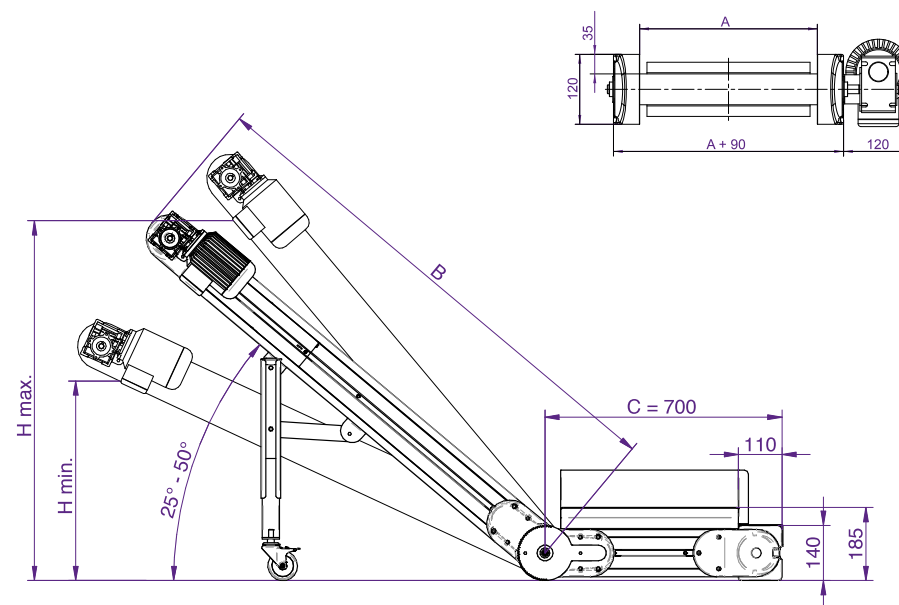

## CHARACTERISTICS

- Necessity of compact, easy-fitting conveyors, suitable for different uses and especially where limited space is a crucial element (e.g. under IMM)
- Adjustable angle from min 25° to max 50°
- Options: unloading chute / loading hopper

## TECHNICAL FEATURES

- Structure made of aluminium anodised profile height 120 mm
- With side panel not removable height 35 mm
- Smooth PU belt, slats h 30 mm pitch 400 mm, vulcanised belt joint. Temperature resistance from -10°C to + 90°C
- Transmission group composed of: three-phase motor, worm reduction unit with lubrication for life
- Fixed standard speed ~3 m/min
- Equipped with Start/Stop motor cut-out
- Standard motor supply voltage 400V/50 Hz

## KNIGHT DIMENSIONS

DIMENSION	A (mm)	B (mm)	H 25° (mm)	H 50° (mm)
KNIGHT.0	155	1500	500	1050
KNIGHT.1	255	1500	500	1050
KNIGHT.2	355	1800	650	1250

➔ The sum of the horizontal section (C) and the inclined section (B) shall not exceed 3000 mm

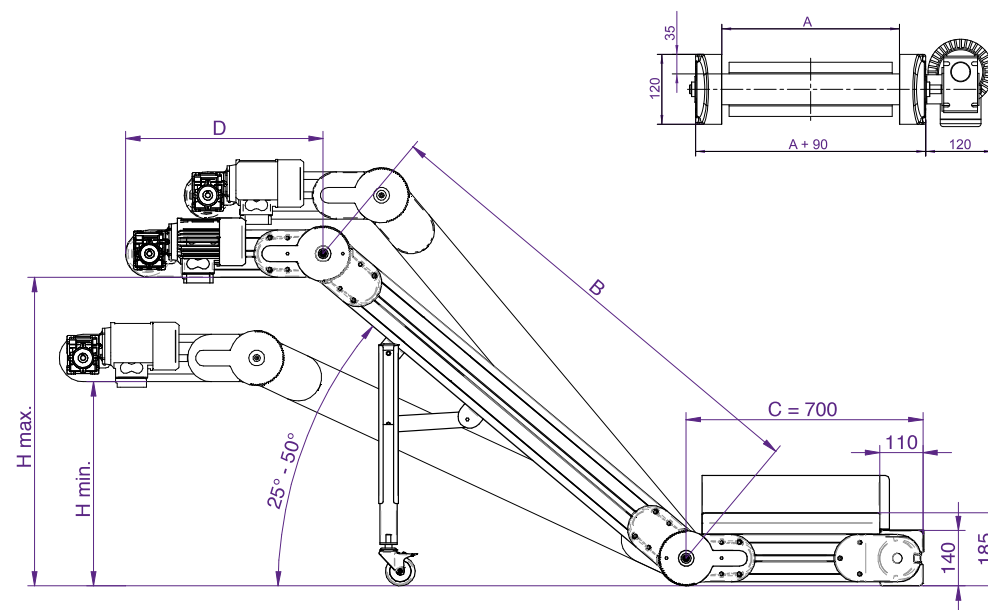

## CHARACTERISTICS

- Necessity of compact, easy-fitting conveyors, suitable for different uses and especially where limited space is a crucial element (e.g. under IMM)
- Adjustable angle from min 25° to max 50°
- Options: unloading chute / loading hopper

## TECHNICAL FEATURES

- Structure made of aluminium anodised profile height 120 mm
- With side panel not removable height 35 mm
- Smooth PU belt, slats h 30 mm pitch 400 mm, vulcanised belt joint.  
Temperature resistance from -10°C to + 90°C
- Transmission group composed of: three-phase motor, worm reduction unit with lubrication for life
- Fixed standard speed ~3 m/min
- Equipped with Start/Stop motor cut-out
- Standard motor supply voltage 400V/50 Hz

## BISHOP DIMENSIONS

DIMENSION	A (mm)	B (mm)	H 25° (mm)	H 50° (mm)
BISHOP.0	155	1500	550	1100
BISHOP.1	255	1500	550	1100
BISHOP.2	355	1800	700	1500

➔ The sum of the horizontal lower section (C), the inclined section (B) and the horizontal upper section (D) shall not exceed 3000 mm