

# PROCESS WATER CHILLERS

**PRODUCTS COLLECTION**  
2019 EDITION

[www.eurochiller.com](http://www.eurochiller.com)

 **EURO  
CHILLER**<sup>®</sup>  
INTERNATIONAL COOLING







119 - 714 kW

AIR COOLED

SCROLL Compressor

R407C Refrigerant

R134A Refrigerant



AIR COOLED

DY-NAX-P  
Plates evaporator

DY-NAX-P  
DY-NAX-P-BT

DY-NAX-FT  
Shell & tube  
evaporator

DY-NAX-FT  
DY-NAX-FT-BT

# Caratteristiche principali / Main features / Hauptmerkmale / Caracteristiques generales / Caracteristicas generales

<b>IT</b>	<b>STRUTTURA</b>	In acciaio zincato preverniciato
	<b>COMPRESSORE</b>	Scroll ad alto rendimento
	<b>VENTILATORI</b>	Assiali
	<b>CONDENSATORE</b>	Condensatori ad aria disposti a V
	<b>EVAPORATORE</b>	A piastre saldo-brasate o a fascio tubiero
	<b>GRUPPO DI ACCUMULO E POMPAGGIO</b>	Esterno (optional)
	<b>CONTROLLO</b>	Pannello a microprocessore con quadro elettrico IP54
	<b>CERTIFICAZIONE</b>	CE - PED
	<b>EXTRA</b>	La serie è conforme alla direttiva ECodesign

<b>ALLESTIMENTO</b>	<b>DY-NAX-P</b> Evaporatore a piastre No pompa/No serbatoio	<b>DY-NAX-FT</b> Evaporatore a fascio tubiero No pompa/No serbatoio	
<b>VERSIONI</b>	<b>T Acqua</b>	<b>T Ambiente</b>	<b>Gas</b>
<b>Standard</b>	+5/+25°C	+40°C	R407c
<b>T</b>	+5/+25°C	+45°C	R407c
<b>ST</b>	+5/+25°C	+50°C	R134a
<b>BT</b>	-5/+10°C	+40°C	R407c

<b>EN</b>	<b>STRUCTURE</b>	Structure manufactured from pre-painted galvanized steel
	<b>COMPRESSORS</b>	Highly efficient Scroll compressors
	<b>FANS</b>	Axial
	<b>CONDENSER</b>	V-shaped air condensers
	<b>EVAPORATOR</b>	Brazed plate or shell & tube evaporator
	<b>PUMP &amp; TANK GROUPS</b>	External (optional)
	<b>CONTROL</b>	Microprocessor control panel with electric panel manufactured to IP54
	<b>CERTIFICATE</b>	CE - PED
	<b>EXTRA</b>	The series complies with the ECodesign directive

<b>DESIGN</b>	<b>DY-NAX-P</b> Plates evaporator No pump/No tank	<b>DY-NAX-FT</b> Shell & tube evaporator No pump/No tank	
<b>VERSIONS</b>	<b>T Water</b>	<b>T Air</b>	<b>Refrigerant</b>
<b>Standard</b>	+5/+25°C	+40°C	R407c
<b>T</b>	+5/+25°C	+45°C	R407c
<b>ST</b>	+5/+25°C	+50°C	R134a
<b>BT</b>	-5/+10°C	+40°C	R407c

<b>DE</b>	<b>STRUKTUR</b>	Gerätegehäuse aus vorbeschichtetem verzinktem Stahl
	<b>KOMPRESSOR</b>	leistungseffiziente Scrollkompressoren
	<b>GEBLÄSE</b>	Axiale Gebläse
	<b>KONDENSATOR</b>	V-förmige luftgekühlte Kondensatoren
	<b>VERDAMPFER</b>	Platten-oder-Rohrbündelverdampfer
	<b>PUMPEN-TANKSTATIONEN</b>	Externe (Optional)
	<b>KONTROLLE</b>	Mikroprozessorbedienfeld mit Schaltkasten IP54 ausgeführt
	<b>ZERTIFIZIERUNG</b>	CE - PED
	<b>EXTRA</b>	Die Serie entspricht der ECodesign Richtlinie

<b>AUSSTATTUNG</b>	<b>DY-NAX-P</b> Plattenverdampfer ohne Pumpe/ohne Tank	<b>DY-NAX-FT</b> Rohrbündelverdampfer ohne Pumpe/ohne Tank	
<b>VERSIONEN</b>	<b>T Wasser</b>	<b>T Luft</b>	<b>Kühlmittel</b>
<b>Standard</b>	+5/+25°C	+40°C	R407c
<b>T</b>	+5/+25°C	+45°C	R407c
<b>ST</b>	+5/+25°C	+50°C	R134a
<b>BT</b>	-5/+10°C	+40°C	R407c

<b>FR</b>	<b>STRUCTURE</b>	Structure en acier zingué galvanisé pré-peint
	<b>COMPRESSEUR</b>	Compresseurs Scroll à haute performance
	<b>VENTILATEURS</b>	Axiale
	<b>CONDENSEUR</b>	Condenseurs à air disposés en V
	<b>ÉVAPORATEUR</b>	Évaporateur à plaques soudo-brasées ou à faisceau tubulaire
	<b>GROUPES DE POMPES ET RÉSERVOIRS</b>	Externe (en option)
	<b>CONTRÔLE</b>	Panneau de commande à microprocesseur avec armoire électrique en protection IP54
	<b>CERTIFICATIONS</b>	CE - PED
	<b>EXTRAS</b>	La série est conforme à la directive ECodesign

<b>CONFIGURATION</b>	<b>DY-NAX-P</b> À plaques Sans pompe/Sans réservoir	<b>DY-NAX-FT</b> À faisceau tubulaire Sans pompe/Sans réservoir	
<b>VERSIONS</b>	<b>T Eau</b>	<b>T Air</b>	<b>Gaz</b>
<b>Standard</b>	+5/+25°C	+40°C	R407c
<b>T</b>	+5/+25°C	+45°C	R407c
<b>ST</b>	+5/+25°C	+50°C	R134a
<b>BT</b>	-5/+10°C	+40°C	R407c

<b>ES</b>	<b>ESTRUCTURA</b>	De acero galvanizado prepintado
	<b>COMPRESOR</b>	Scroll de alto rendimiento
	<b>VENTILADORES</b>	Axiales
	<b>CONDENSADORES</b>	De aire colocados en forma de V
	<b>EVAPORADOR</b>	De placas soldadas o tubular
	<b>GRUPOS DE ACUMULACIÓN Y BOMBAS</b>	Externos (opcional)
	<b>CONTROL</b>	Panel de mando con microprocesador y cuadro eléctrico IP54
	<b>CERTIFICACIONES</b>	CE - PED
	<b>EXTRAS</b>	La serie cumple con la directiva ECodesign

<b>CONFIGURACIÓN</b>	<b>DY-NAX-P</b> De placas Sin bomba/Sin tanque	<b>DY-NAX-FT</b> Tubular Sin bomba/Sin tanque	
<b>VERSIONS</b>	<b>T Agua</b>	<b>T Aire</b>	<b>Gas</b>
<b>Standard</b>	+5/+25°C	+40°C	R407c
<b>T</b>	+5/+25°C	+45°C	R407c
<b>ST</b>	+5/+25°C	+50°C	R134a
<b>BT</b>	-5/+10°C	+40°C	R407c

## HORIZON

Permette la **supervisione di una rete di macchine EUROCHILLER** (max. 10) come un unico sistema, ottimizzandone il funzionamento, **facendo interagire tutte le unità tra di loro in modo dinamico in funzione delle richieste dell'utenza e delle condizioni ambientali.**

Il sistema è predisposto per il monitoraggio remoto macchine ON-AIR.

It allows the **supervision of a network of EUROCHILLER machines** (max 10) as a single system, optimizing their operation, **letting all the units interact dynamically, according to the user's requirements and to the environmental conditions.**  
The system includes the ON-AIR monitoring control.

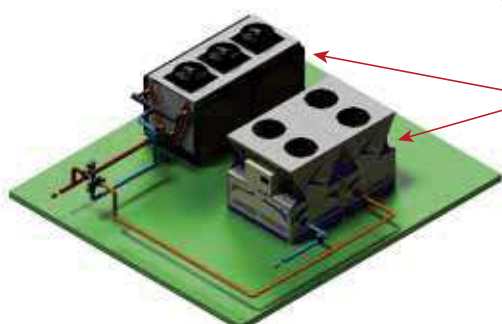

### SISTEMA DI SUPERVISIONE UNITÀ HORIZON

### HORIZON SYSTEM FOR UNITS SUPERVISION



### E-BRAIN control

Permette l'**ottimizzazione della temperatura dell'acqua di condensazione degli IceTemp** (max. 15) in funzione della temperatura ambiente e dei vari set-point impostati per l'acqua di processo, **regolando automaticamente il set-point di ADC/DC** (max. 5) per garantire la massima efficienza degli IceTemp-FC

It allows the **optimization of the condensing water of the IceTemp** (max. 15) according to the ambient temperature and the different set-points of the process water, **automatically adjusting the set-point of the ADC/DC** (max. 5) to grant the best efficiency of the IceTemp-FC.

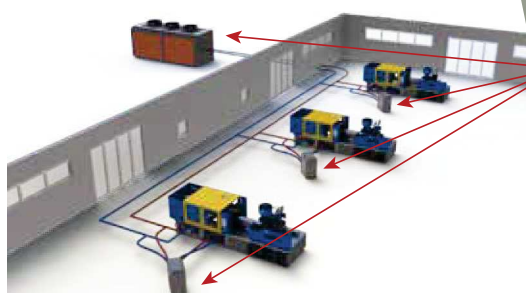

### SISTEMA DI INTERFACCIAMENTO ICETEMP-FC CON ADC/DC

### SYSTEM FOR ICETEMP-FC AND ADC/DC INTERFACE

# REMOTE CONTROL and SYSTEM MONITORING

## EUROCHILLER ON-AIR

### SISTEMA DI CONTROLLO REMOTO ON-AIR

### ON-AIR REMOTE CONTROL SYSTEM



Sistema di monitoraggio remoto dei nostri sistemi di refrigerazione e termoregolazione, che permette:  
Remote control system of our cooling and temperature control units, allowing:



**SUPERVISIONE LOCALE:** Monitoraggio in loco a cura dell'utilizzatore finale.  
**LOCAL SUPERVISION:** On site monitoring by the end-user.

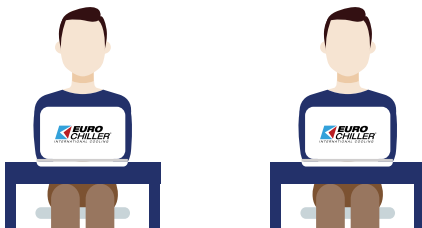

**MONITORAGGIO REMOTO:** Controllo in linea del funzionamento dell'unità e dei suoi parametri (a cura EUROCHILLER o centro assistenza autorizzato).  
**REMOTE MONITORING:** On-line control of the operation of the unit and of its parameters (EUROCHILLER or authorized technical service).



**ASSISTENZA REMOTA:** Interazione con l'utilizzatore finale in caso di anomalie.  
**REMOTE ASSISTANCE:** Interaction with the end-user in case of malfunctions.



**INTERVENTO IMMEDIATO:** L'assistenza rileva in tempo reale la necessità di intervenire e può quindi reagire con immediatezza.  
**PROMPT INTERVENTION:** The service is notified in real time when intervention is required and may react promptly.



**REPORT TRIMESTRALI:** Report dettagliati delle condizioni di lavoro.  
**QUARTERLY REPORTS:** Detailed reports of operating conditions.



# PROCESS AIR CHILLERS & DEHUMIDIFIERS

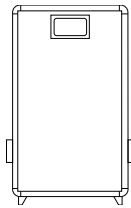

11-19 kW 1000-1500 m<sup>3</sup>/h

**MINI ABF**

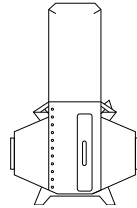

13-94 kW 1000-7500 m<sup>3</sup>/h

**AIR+**

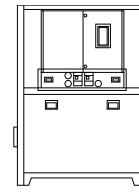

29-230 kW 2000-10000 m<sup>3</sup>/h

**ABFevo**

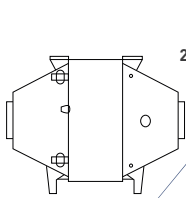

2-169 kW 250-17000 m<sup>3</sup>/h

**BRA+**

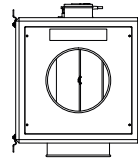

max. 20000 m<sup>3</sup>/h

**AMK**

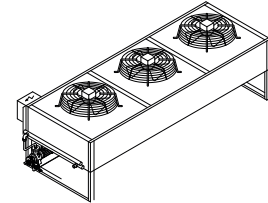

21-200 kW

**OFC KIT**

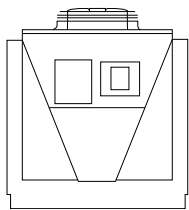

82-1220 kW

**ADcooler KIT**

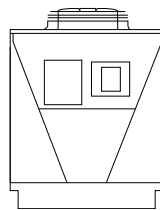

63-920 kW

**Dcooler KIT**

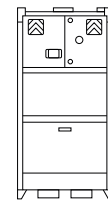

400-3000 m<sup>3</sup>/h

**EU-DRYmould**

# TEMPERATURE CONTROL UNITS

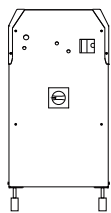

3 - 12 kW

**STARTY**

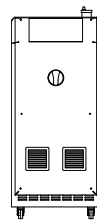

3 - 24 kW

**MAXY**

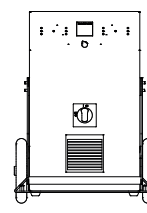

3 - 24 kW

**3FLOWSevo**

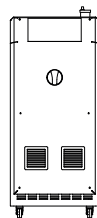

3 - 12 kW

**3FLEX**

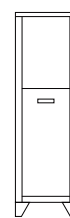

3 - 150 kW

**ETO - ETW**

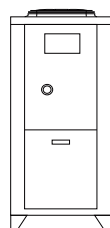

6 - 36 kW 13 - 130 kW

**ROSSOBLU**



3 - 18 kW 4 - 98 kW

**ICETEMP**





# PROCESS WATER CHILLERS

**PRODUCTS COLLECTION**  
2019 EDITION

EUROCHILLER S.r.l. - Via Milano, 69 - 27030 Castello d'Agogna - PV - Italy  
Tel. +39 0384.298985 - Fax +39 0384.298984 - Service +39 0384.298981  
enquiry@eurochiller.com - www.eurochiller.com

**EUROCHILLERGROUP**